

STERI-PLUS EXHALATION FILTER FOR SOURCE CONTROL

World's first exhalation valve filter for PAPR for source control in sterile settings.

Suitable for use in patient care settings and laboratory/ pharmaceutical clean rooms

Developed specifically for sterile environments where filtering of the wearer's exhaled air is required.

Provides reliable source control for CleanSpace respirators, when used with the half mask.



Scan to watch
the video

STERI-PLUS: HOW TO USE



STEP 1. Insert a new filter to the blue outer case.

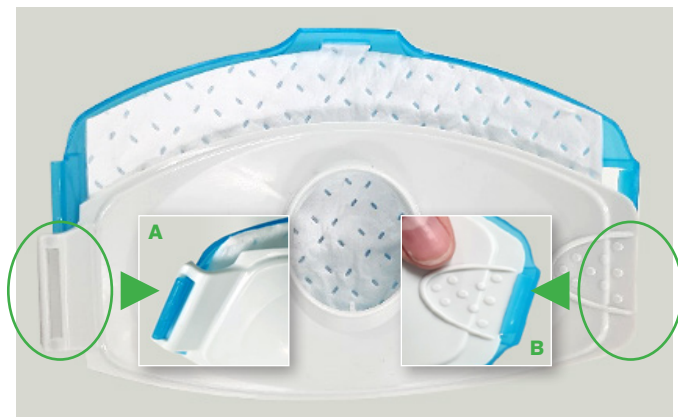

STEP 3. Correctly place the white inner case over the filter (see image above). Align the end (A) to slot in and then close and clip the case shut (B).

CODE PRODUCT NAME

CS3038 Steri-Plus Case: Exhalation Valve Filter Case (Reusable)

CS3039 Steri-Plus Filter: Exhalation Valve Filter (Consumable), Pk 20

WWW.CLEANSPACETECHNOLOGY.COM sales@cleanspacetechnology.com



FEATURES:

- Use with CleanSpace half masks
- Reusable case is compatible with standard disinfection/sterilization protocols
- Filtration efficiency 99% for particles 0.3µm and above
- Easy to fit. Easy to clean
- Cost effective
- Approved for use with CleanSpace respirators

PARTS:

- Case: outer (polycarbonate) and inner case (ABS, reusable)
- Filter media: nonwoven electrostatic (consumable)



STEP 2. Ensure filter tabs are positioned in the case slots to hold the filter in place.



STEP 4. Align the assembled case with filter to the mask exhalation cap so the outer case vents are at the bottom of the mask. Click the case onto the exhalation valve seat. NOTE: The exhalation valve cap can remain in place.

Contact CleanSpace Technology to request a demonstration

